

ms Westerdam

DECK PLANS & STATEROOMS

The deck plans are color-coded by category of stateroom, and the category letter precedes the stateroom number in each room. All staterooms are equipped with flat-panel television, DVD player, mini-bar, mini-safe, data port, telephone and multichannel music.

Important Note: Not all staterooms within each category have the same furniture configuration and/or facilities. Appropriate symbols within the rooms on the deck plans describe differences from the stateroom descriptions below.

All information is subject to change.

STATEROOM SYMBOL LEGEND

- Triple (2 lower beds, 1 sofa bed)
- Quad (2 lower beds, 1 sofa bed, 1 upper)
- △ Partial sea view
- × Fully obstructed view
- + Connecting rooms
- * Shower only
- ♣ Single sink vanity
- ◆ Staterooms have solid steel verandah railings instead of clear-view Plexiglas® railings
- ♿ Suites SY8068, SC6175, SC6164, SY5002 & SY5001 are wheelchair accessible, bathtub and roll-in shower. Suite SS6108 and staterooms I-8037, VA8032, VA8031, VA6049, VB6004, VB6003, VA5140, VA5137, VA5054, VA5051, VA4132, VA4131, H4090, H4089, VA4052, VA4051, D1100, C1082, C1081, J1074, K1012 & K1011 are wheelchair accessible, roll-in shower only.

OCEAN-VIEW STATEROOMS

C **D** **DD** **E** **F**

Large: 2 lower beds convertible to 1 queen-size bed, bathtub & shower.
Approximately 174–180 sq. ft.

INTERIOR STATEROOMS

J

Large: 2 lower beds convertible to 1 queen-size bed, shower.
Approximately 151–233 sq. ft.

K

Large or Standard: 2 lower beds convertible to 1 queen-size bed, shower.
Approximately 151–233 sq. ft.

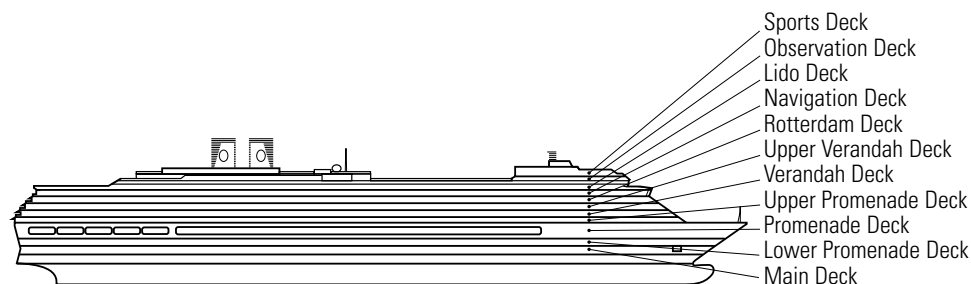

DECK 1—MAIN DECK

Staterooms 1001–1127

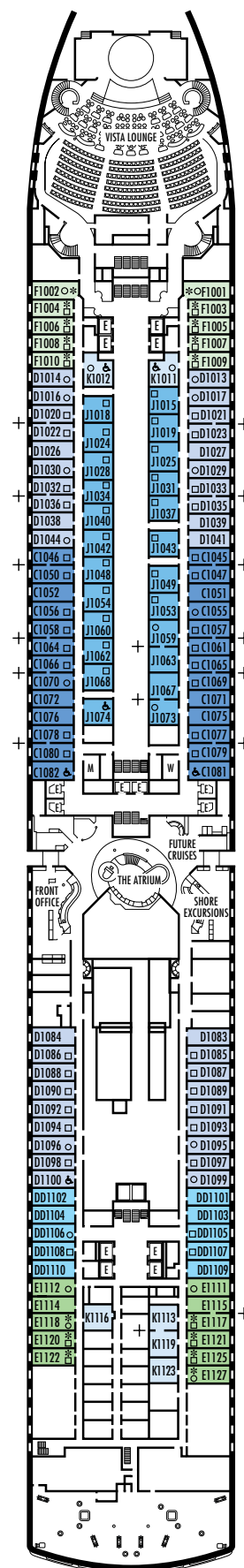

ms Westerdam

DECK PLANS & STATEROOMS

The deck plans are color-coded by category of stateroom, and the category letter precedes the stateroom number in each room. All staterooms are equipped with flat-panel television, DVD player, mini-bar, mini-safe, data port, telephone and multichannel music.

Important Note: Not all staterooms within each category have the same furniture configuration and/or facilities. Appropriate symbols within the rooms on the deck plans describe differences from the stateroom descriptions below.

All information is subject to change.

STATEROOM SYMBOL LEGEND

- Triple (2 lower beds, 1 sofa bed)
- Quad (2 lower beds, 1 sofa bed, 1 upper)
- △ Partial sea view
- × Fully obstructed view
- + Connecting rooms
- * Shower only
- ♣ Single sink vanity
- ◆ Staterooms have solid steel verandah railings instead of clear-view Plexiglas® railings
- ♿ Suites SY8068, SC6175, SC6164, SY5002 & SY5001 are wheelchair accessible, bathtub and roll-in shower. Suite SS6108 and staterooms I-8037, VA8032, VA8031, VA6049, VB6004, VB6003, VA5140, VA5137, VA5054, VA5051, VA4132, VA4131, H4090, H4089, VA4052, VA4051, D1100, C1082, C1081, J1074, K1012 & K1011 are wheelchair accessible, roll-in shower only.

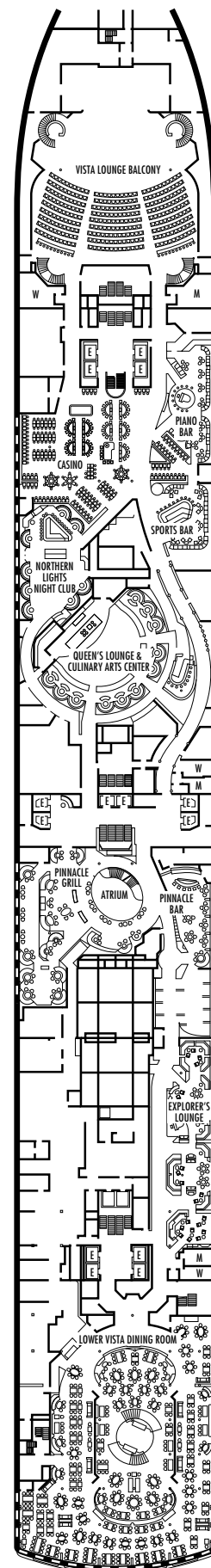
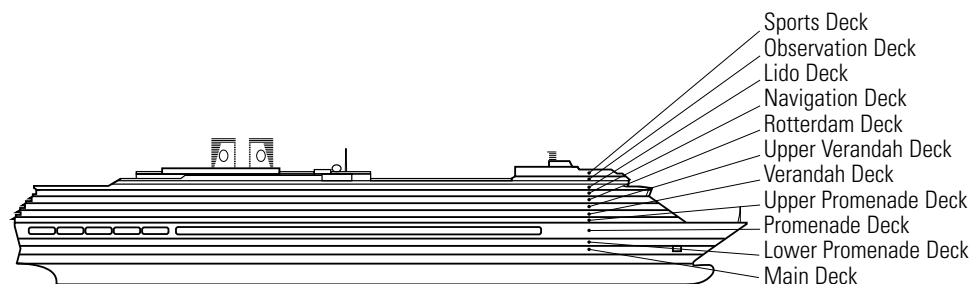

ms Westerdam

DECK PLANS & STATEROOMS

The deck plans are color-coded by category of stateroom, and the category letter precedes the stateroom number in each room. All staterooms are equipped with flat-panel television, DVD player, mini-bar, mini-safe, data port, telephone and multichannel music.

Important Note: Not all staterooms within each category have the same furniture configuration and/or facilities. Appropriate symbols within the rooms on the deck plans describe differences from the stateroom descriptions below.

All information is subject to change.

STATEROOM SYMBOL LEGEND

- Triple (2 lower beds, 1 sofa bed)
- Quad (2 lower beds, 1 sofa bed, 1 upper)
- △ Partial sea view
- × Fully obstructed view
- + Connecting rooms
- * Shower only
- ♣ Single sink vanity
- ◆ Staterooms have solid steel verandah railings instead of clear-view Plexiglas® railings
- ♿ Suites SY8068, SC6175, SC6164, SY5002 & SY5001 are wheelchair accessible, bathtub and roll-in shower. Suite SS6108 and staterooms I-8037, VA8032, VA8031, VA6049, VB6004, VB6003, VA5140, VA5137, VA5054, VA5051, VA4132, VA4131, H4090, H4089, VA4052, VA4051, D1100, C1082, C1081, J1074, K1012 & K1011 are wheelchair accessible, roll-in shower only.

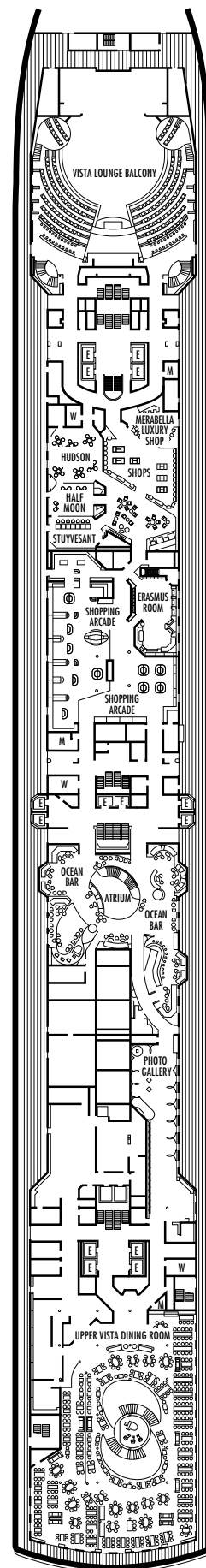
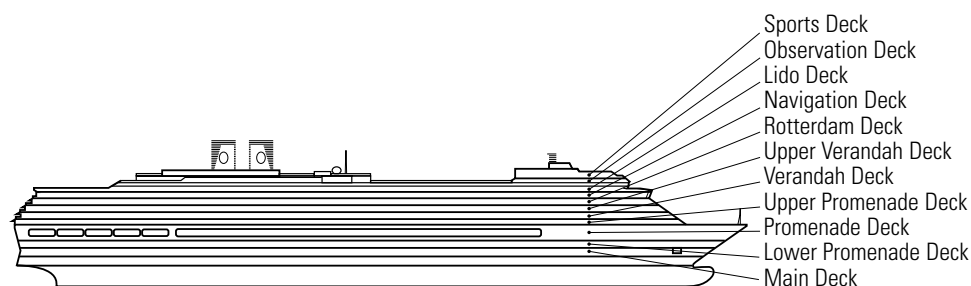

ms Westerdam

DECK PLANS & STATEROOMS

The deck plans are color-coded by category of stateroom, and the category letter precedes the stateroom number in each room. All staterooms are equipped with flat-panel television, DVD player, mini-bar, mini-safe, data port, telephone and multichannel music.

Important Note: Not all staterooms within each category have the same furniture configuration and/or facilities. Appropriate symbols within the rooms on the deck plans describe differences from the stateroom descriptions below.

All information is subject to change.

STATEROOM SYMBOL LEGEND

- Triple (2 lower beds, 1 sofa bed)
- Quad (2 lower beds, 1 sofa bed, 1 upper)
- △ Partial sea view
- × Fully obstructed view
- + Connecting rooms
- * Shower only
- ♠ Single sink vanity
- ◆ Staterooms have solid steel verandah railings instead of clear-view Plexiglas® railings
- ♿ Suites SY8068, SC6175, SC6164, SY5002 & SY5001 are wheelchair accessible, bathtub and roll-in shower. Suite SS6108 and staterooms I-8037, VA8032, VA8031, VA6049, VB6004, VB6003, VA5140, VA5137, VA5054, VA5051, VA4132, VA4131, H4090, H4089, VA4052, VA4051, D1100, C1082, C1081, J1074, K1012 & K1011 are wheelchair accessible, roll-in shower only.

VERANDAH SUITES

SB

Neptune Suites: (Deluxe Verandah Suites)
2 lower beds convertible to 1 king-size bed, bathroom with dual sink vanity, full-size whirlpool bath & shower & additional shower stall, large sitting area, dressing room, private verandah, 1 sofa bed for 2 persons, floor-to-ceiling windows. Approximately 500–712 sq. ft. including verandah.

VERANDAH STATEROOMS

VA VB VC VE VF VH

Verandah: 2 lower beds convertible to 1 queen-size bed, bathtub & shower, sitting area, private verandah, floor-to-ceiling windows. Approximately 212–359 sq. ft. including verandah.

OCEAN-VIEW STATEROOMS

D

Large: 2 lower beds convertible to 1 queen-size bed, bathtub & shower. Approximately 174–180 sq. ft.

G H HH

Large: 2 lower beds convertible to 1 queen-size bed, bathtub & shower. All G-category staterooms have partial sea views. All H- & HH-category staterooms have fully obstructed views. Approximately 174–180 sq. ft.

INTERIOR STATEROOMS

K

Large or Standard: 2 lower beds convertible to 1 queen-size bed, shower. Approximately 151–233 sq. ft.

L N

Standard: 2 lower beds convertible to 1 queen-size bed, shower. Approximately 151–233 sq. ft.

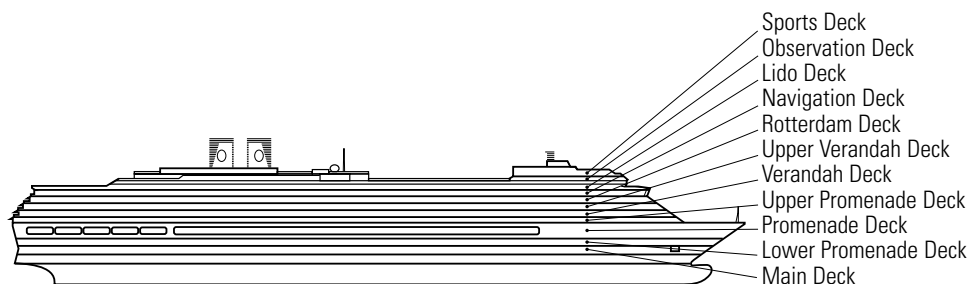

DECK 4—UPPER PROMENADE DECK

Staterooms 4001–4185

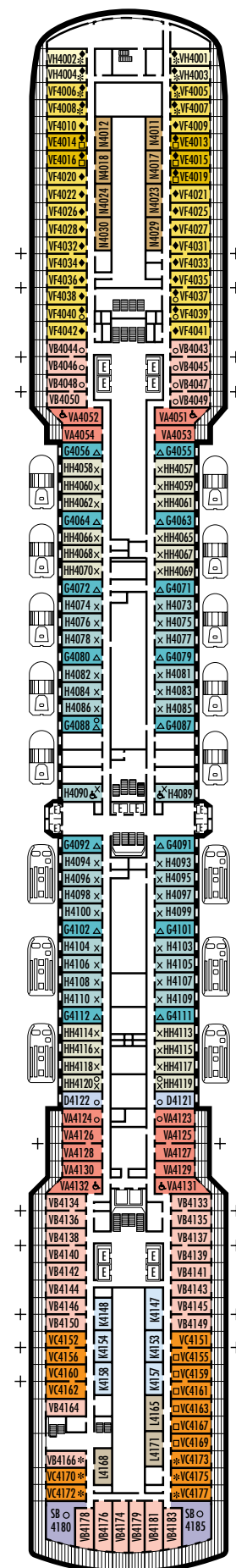

ms Westerdam

DECK PLANS & STATEROOMS

The deck plans are color-coded by category of stateroom, and the category letter precedes the stateroom number in each room. All staterooms are equipped with flat-panel television, DVD player, mini-bar, mini-safe, data port, telephone and multichannel music.

Important Note: Not all staterooms within each category have the same furniture configuration and/or facilities. Appropriate symbols within the rooms on the deck plans describe differences from the stateroom descriptions below.

All information is subject to change.

STATEROOM SYMBOL LEGEND

- Triple (2 lower beds, 1 sofa bed)
- Quad (2 lower beds, 1 sofa bed, 1 upper)
- △ Partial sea view
- × Fully obstructed view
- + Connecting rooms
- * Shower only
- ♠ Single sink vanity
- ◆ Staterooms have solid steel verandah railings instead of clear-view Plexiglas® railings
- ♿ Suites SY8068, SC6175, SC6164, SY5002 & SY5001 are wheelchair accessible, bathtub and roll-in shower. Suite SS6108 and staterooms I-8037, VA8032, VA8031, VA6049, VB6004, VB6003, VA5140, VA5137, VA5054, VA5051, VA4132, VA4131, H4090, H4089, VA4052, VA4051, D1100, C1082, C1081, J1074, K1012 & K1011 are wheelchair accessible, roll-in shower only.

VERANDAH SUITES

SB

Neptune Suites: (Deluxe Verandah Suites)
2 lower beds convertible to 1 king-size bed, bathroom with dual sink vanity, full-size whirlpool bath & shower & additional shower stall, large sitting area, dressing room, private verandah, 1 sofa bed for 2 persons, floor-to-ceiling windows. Approximately 500–712 sq. ft. including verandah.

SY

Signature Suites: (Superior Verandah Suites)
2 lower beds convertible to 1 queen-size bed, bathroom with dual sink vanity, full-size whirlpool bath & shower & additional shower stall, large sitting area, private verandah, 1 sofa bed for 1 person, floor-to-ceiling windows. Approximately 372–384 sq. ft. including verandah.

VERANDAH STATEROOMS

VA VB VC

Verandah: 2 lower beds convertible to 1 queen-size bed, bathtub & shower, sitting area, private verandah, floor-to-ceiling windows. Approximately 212–359 sq. ft. including verandah.

INTERIOR STATEROOMS

K

Large or Standard: 2 lower beds convertible to 1 queen-size bed, shower. Approximately 151–233 sq. ft.

L

Standard: 2 lower beds convertible to 1 queen-size bed, shower. Approximately 151–233 sq. ft.

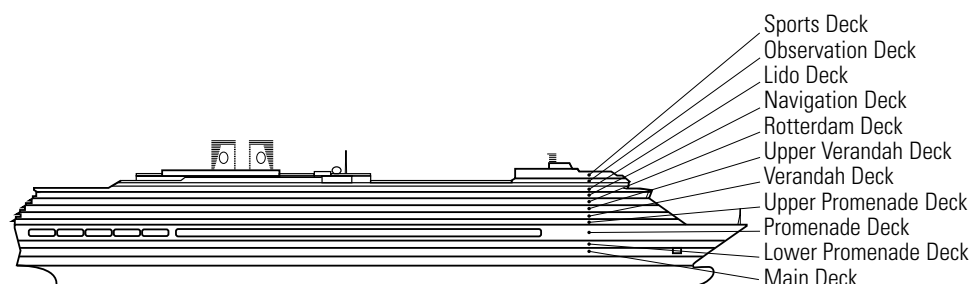

DECK 5 – VERANDAH DECK

Staterooms 5001–5191

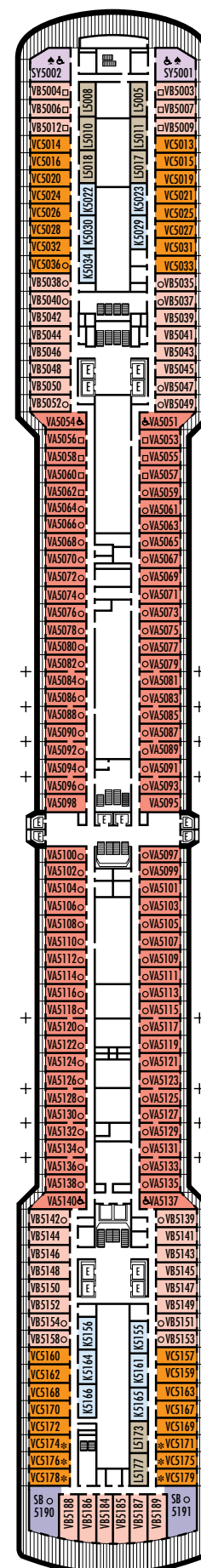

ms Westerdam

DECK PLANS & STATEROOMS

The deck plans are color-coded by category of stateroom, and the category letter precedes the stateroom number in each room. All staterooms are equipped with flat-panel television, DVD player, mini-bar, mini-safe, data port, telephone and multichannel music.

Important Note: Not all staterooms within each category have the same furniture configuration and/or facilities. Appropriate symbols within the rooms on the deck plans describe differences from the stateroom descriptions below.

All information is subject to change.

STATEROOM SYMBOL LEGEND

- Triple (2 lower beds, 1 sofa bed)
- Quad (2 lower beds, 1 sofa bed, 1 upper)
- △ Partial sea view
- × Fully obstructed view
- + Connecting rooms
- * Shower only
- ♣ Single sink vanity
- ◆ Staterooms have solid steel verandah railings instead of clear-view Plexiglas® railings
- ♿ Suites SY8068, SC6175, SC6164, SY5002 & SY5001 are wheelchair accessible, bathtub and roll-in shower. Suite SS6108 and staterooms I-8037, VA8032, VA8031, VA6049, VB6004, VB6003, VA5140, VA5137, VA5054, VA5051, VA4132, VA4131, H4090, H4089, VA4052, VA4051, D1100, C1082, C1081, J1074, K1012 & K1011 are wheelchair accessible, roll-in shower only.

VERANDAH SUITES

SB SC

Neptune Suites: (Deluxe Verandah Suites)
2 lower beds convertible to 1 king-size bed, bathroom with dual sink vanity, full-size whirlpool bath & shower & additional shower stall, large sitting area, dressing room, private verandah, 1 sofa bed for 2 persons, floor-to-ceiling windows. Approximately 500–712 sq. ft. including verandah.

SS

Signature Suites: (Superior Verandah Suites)
2 lower beds convertible to 1 queen-size bed, bathroom with dual sink vanity, full-size whirlpool bath & shower & additional shower stall, large sitting area, private verandah, 1 sofa bed for 1 person, floor-to-ceiling windows. Approximately 372–384 sq. ft. including verandah.

VERANDAH STATEROOMS

VA VB VC VD

Verandah: 2 lower beds convertible to 1 queen-size bed, bathtub & shower, sitting area, private verandah, floor-to-ceiling windows. Approximately 213–359 sq. ft. including verandah.

OCEAN-VIEW STATEROOMS

F

Large: 2 lower beds convertible to 1 queen-size bed, bathtub & shower. Approximately 174–180 sq. ft.

INTERIOR STATEROOMS

I K

Large or Standard: 2 lower beds convertible to 1 queen-size bed, shower. Approximately 151–233 sq. ft.

L

Standard: 2 lower beds convertible to 1 queen-size bed, shower. Approximately 151–233 sq. ft.

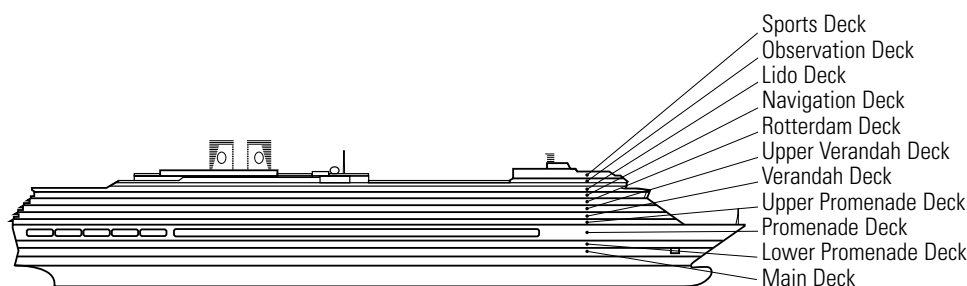

DECK 6—UPPER VERANDAH DECK

Staterooms 6001–6177

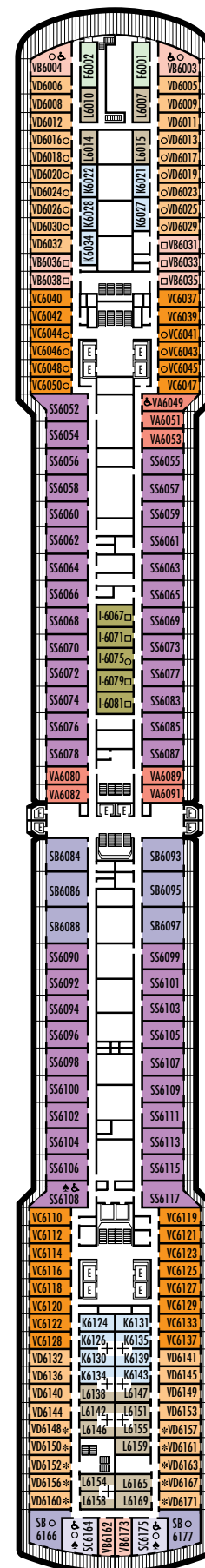

ms Westerdam

DECK PLANS & STATEROOMS

The deck plans are color-coded by category of stateroom, and the category letter precedes the stateroom number in each room. All staterooms are equipped with flat-panel television, DVD player, mini-bar, mini-safe, data port, telephone and multichannel music.

Important Note: Not all staterooms within each category have the same furniture configuration and/or facilities. Appropriate symbols within the rooms on the deck plans describe differences from the stateroom descriptions below.

All information is subject to change.

STATEROOM SYMBOL LEGEND

- Triple (2 lower beds, 1 sofa bed)
- Quad (2 lower beds, 1 sofa bed, 1 upper)
- △ Partial sea view
- × Fully obstructed view
- + Connecting rooms
- * Shower only
- ♠ Single sink vanity
- ◆ Staterooms have solid steel verandah railings instead of clear-view Plexiglas® railings
- ♿ Suites SY8068, SC6175, SC6164, SY5002 & SY5001 are wheelchair accessible, bathtub and roll-in shower. Suite SS6108 and staterooms I-8037, VA8032, VA8031, VA6049, VB6004, VB6003, VA5140, VA5137, VA5054, VA5051, VA4132, VA4131, H4090, H4089, VA4052, VA4051, D1100, C1082, C1081, J1074, K1012 & K1011 are wheelchair accessible, roll-in shower only.

VERANDAH SUITES

PS

Pinnacle Suites: (Penthouse Verandah Suites) Bedroom with 1 king-size bed, oversize whirlpool bath & shower & additional shower stall, living room, dining room, dressing room, private verandah with whirlpool, pantry, 1 sofa bed for 2 persons, microwave, refrigerator, guest toilet, private stereo system, floor-to-ceiling windows. Approximately 1,150 sq. ft. including verandah.

SA SB SC

Neptune Suites: (Deluxe Verandah Suites) 2 lower beds convertible to 1 king-size bed, bathroom with dual sink vanity, full-size whirlpool bath & shower & additional shower stall, large sitting area, dressing room, private verandah, 1 sofa bed for 2 persons, floor-to-ceiling windows. Approximately 500–712 sq. ft. including verandah.

VERANDAH STATEROOMS

VB VD VE

Verandah: 2 lower beds convertible to 1 queen-size bed, bathtub & shower, sitting area, private verandah, floor-to-ceiling windows. Approximately 212–359 sq. ft. including verandah.

INTERIOR STATEROOMS

I

Large or Standard: 2 lower beds convertible to 1 queen-size bed, shower. Approximately 151–233 sq. ft.

L M

Standard: 2 lower beds convertible to 1 queen-size bed, shower. Approximately 151–233 sq. ft.

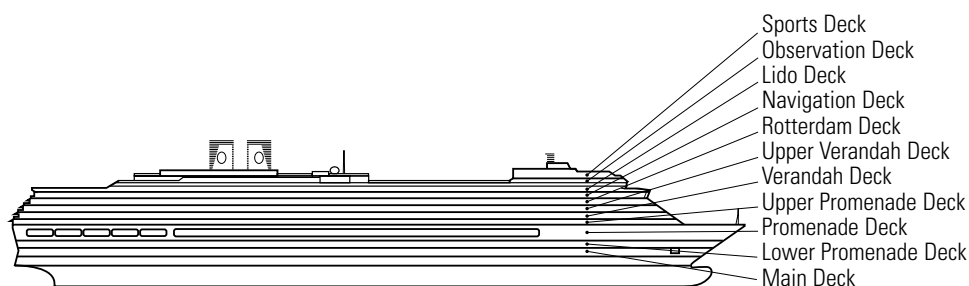

DECK 7 – ROTTERDAM DECK

Staterooms 7001–7151

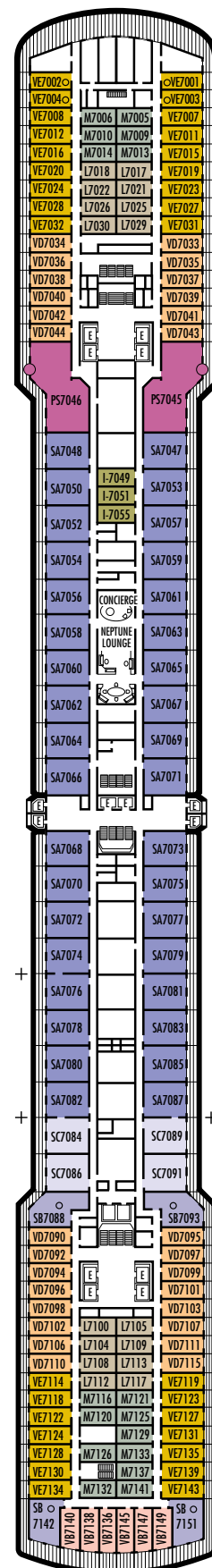

ms Westerdam

DECK PLANS & STATEROOMS

The deck plans are color-coded by category of stateroom, and the category letter precedes the stateroom number in each room. All staterooms are equipped with flat-panel television, DVD player, mini-bar, mini-safe, data port, telephone and multichannel music.

Important Note: Not all staterooms within each category have the same furniture configuration and/or facilities. Appropriate symbols within the rooms on the deck plans describe differences from the stateroom descriptions below.

All information is subject to change.

STATEROOM SYMBOL LEGEND

- Triple (2 lower beds, 1 sofa bed)
- Quad (2 lower beds, 1 sofa bed, 1 upper)
- △ Partial sea view
- × Fully obstructed view
- + Connecting rooms
- * Shower only
- ♠ Single sink vanity
- ◆ Staterooms have solid steel verandah railings instead of clear-view Plexiglas® railings
- ♿ Suites SY8068, SC6175, SC6164, SY5002 & SY5001 are wheelchair accessible, bathtub and roll-in shower. Suite SS6108 and staterooms I-8037, VA8032, VA8031, VA6049, VB6004, VB6003, VA5140, VA5137, VA5054, VA5051, VA4132, VA4131, H4090, H4089, VA4052, VA4051, D1100, C1082, C1081, J1074, K1012 & K1011 are wheelchair accessible, roll-in shower only.

VERANDAH SUITES

SB

Neptune Suites: (Deluxe Verandah Suites)
2 lower beds convertible to 1 king-size bed, bathroom with dual sink vanity, full-size whirlpool bath & shower & additional shower stall, large sitting area, dressing room, private verandah, 1 sofa bed for 2 persons, floor-to-ceiling windows. Approximately 500–712 sq. ft. including verandah.

SY SZ

Signature Suites: (Superior Verandah Suites)
2 lower beds convertible to 1 queen-size bed, bathroom with dual sink vanity, full-size whirlpool bath & shower & additional shower stall, large sitting area, private verandah, 1 sofa bed for 1 person, floor-to-ceiling windows. Approximately 372–384 sq. ft. including verandah.

VERANDAH STATEROOMS

VA VC VE VF

Verandah: 2 lower beds convertible to 1 queen-size bed, bathtub & shower, sitting area, private verandah, floor-to-ceiling windows. Approximately 212–359 sq. ft. including verandah.

INTERIOR STATEROOMS

I MM

Large or Standard: 2 lower beds convertible to 1 queen-size bed, shower. Approximately 151–233 sq. ft.

DECK 8 – NAVIGATION DECK

Staterooms 8001–8147

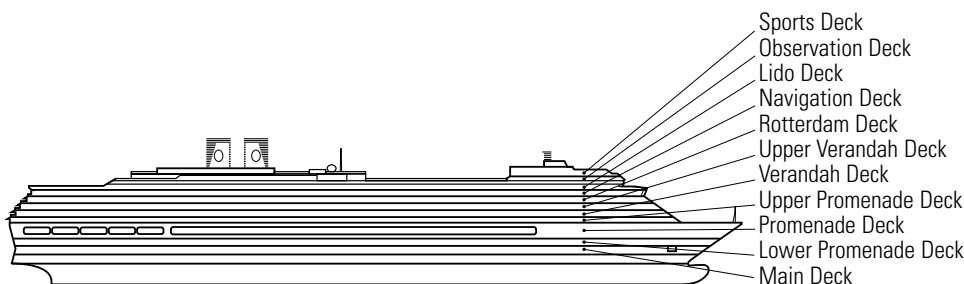
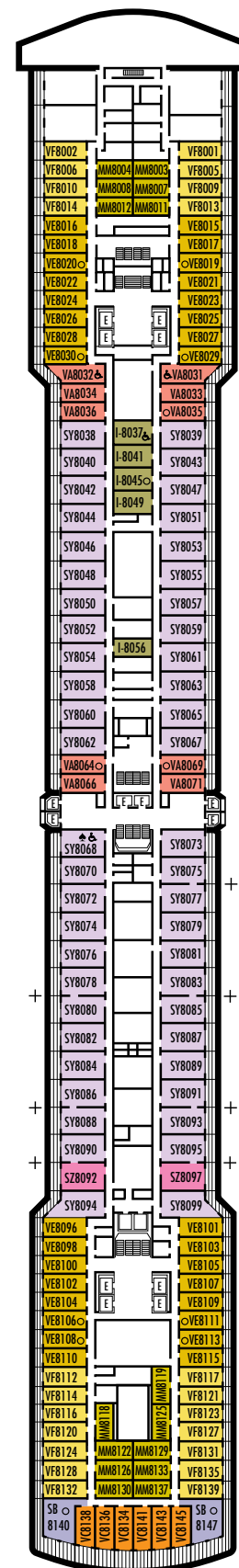

ms Westerdam

DECK PLANS & STATEROOMS

The deck plans are color-coded by category of stateroom, and the category letter precedes the stateroom number in each room. All staterooms are equipped with flat-panel television, DVD player, mini-bar, mini-safe, data port, telephone and multichannel music.

Important Note: Not all staterooms within each category have the same furniture configuration and/or facilities. Appropriate symbols within the rooms on the deck plans describe differences from the stateroom descriptions below.

All information is subject to change.

STATEROOM SYMBOL LEGEND

- Triple (2 lower beds, 1 sofa bed)
- Quad (2 lower beds, 1 sofa bed, 1 upper)
- △ Partial sea view
- × Fully obstructed view
- + Connecting rooms
- * Shower only
- ♣ Single sink vanity
- ◆ Staterooms have solid steel verandah railings instead of clear-view Plexiglas® railings
- ♿ Suites SY8068, SC6175, SC6164, SY5002 & SY5001 are wheelchair accessible, bathtub and roll-in shower. Suite SS6108 and staterooms I-8037, VA8032, VA8031, VA6049, VB6004, VB6003, VA5140, VA5137, VA5054, VA5051, VA4132, VA4131, H4090, H4089, VA4052, VA4051, D1100, C1082, C1081, J1074, K1012 & K1011 are wheelchair accessible, roll-in shower only.

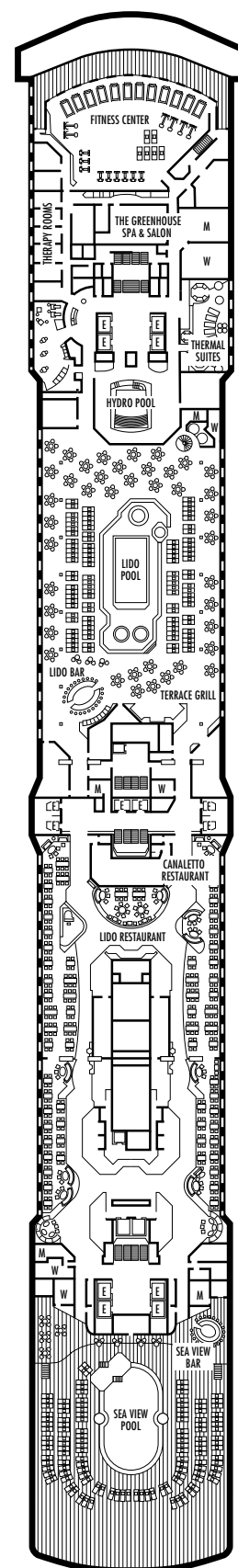
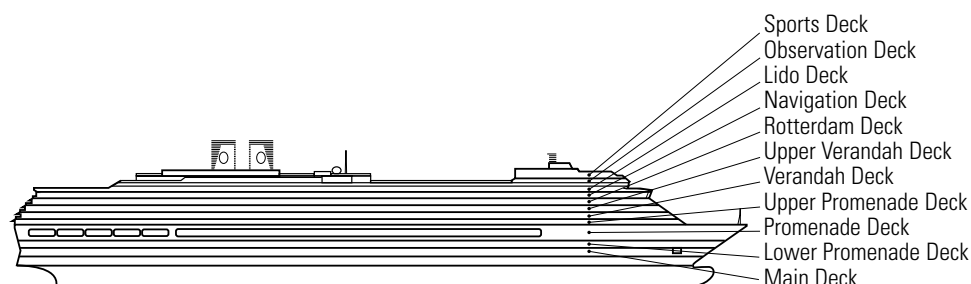

ms Westerdam

DECK PLANS & STATEROOMS

The deck plans are color-coded by category of stateroom, and the category letter precedes the stateroom number in each room. All staterooms are equipped with flat-panel television, DVD player, mini-bar, mini-safe, data port, telephone and multichannel music.

Important Note: Not all staterooms within each category have the same furniture configuration and/or facilities. Appropriate symbols within the rooms on the deck plans describe differences from the stateroom descriptions below.

All information is subject to change.

STATEROOM SYMBOL LEGEND

- Triple (2 lower beds, 1 sofa bed)
- Quad (2 lower beds, 1 sofa bed, 1 upper)
- △ Partial sea view
- × Fully obstructed view
- + Connecting rooms
- * Shower only
- ♣ Single sink vanity
- ◆ Staterooms have solid steel verandah railings instead of clear-view Plexiglas® railings
- ♿ Suites SY8068, SC6175, SC6164, SY5002 & SY5001 are wheelchair accessible, bathtub and roll-in shower. Suite SS6108 and staterooms I-8037, VA8032, VA8031, VA6049, VB6004, VB6003, VA5140, VA5137, VA5054, VA5051, VA4132, VA4131, H4090, H4089, VA4052, VA4051, D1100, C1082, C1081, J1074, K1012 & K1011 are wheelchair accessible, roll-in shower only.

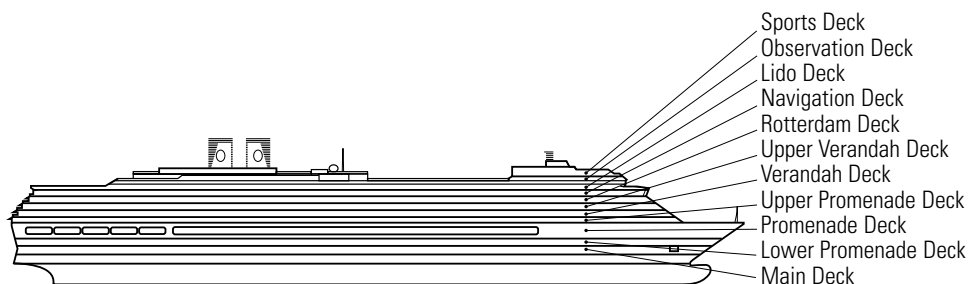
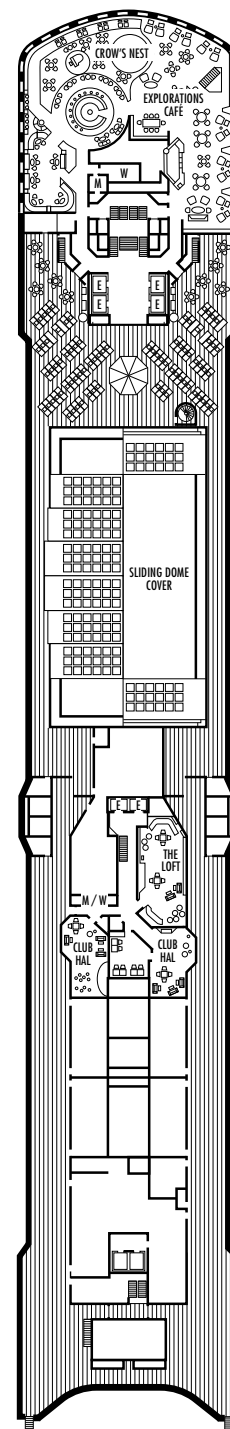

ms Westerdam

DECK PLANS & STATEROOMS

The deck plans are color-coded by category of stateroom, and the category letter precedes the stateroom number in each room. All staterooms are equipped with flat-panel television, DVD player, mini-bar, mini-safe, data port, telephone and multichannel music.

Important Note: Not all staterooms within each category have the same furniture configuration and/or facilities. Appropriate symbols within the rooms on the deck plans describe differences from the stateroom descriptions below.

All information is subject to change.

STATEROOM SYMBOL LEGEND

- Triple (2 lower beds, 1 sofa bed)
- Quad (2 lower beds, 1 sofa bed, 1 upper)
- △ Partial sea view
- × Fully obstructed view
- + Connecting rooms
- * Shower only
- ♣ Single sink vanity
- ◆ Staterooms have solid steel verandah railings instead of clear-view Plexiglas® railings
- ♿ Suites SY8068, SC6175, SC6164, SY5002 & SY5001 are wheelchair accessible, bathtub and roll-in shower. Suite SS6108 and staterooms I-8037, VA8032, VA8031, VA6049, VB6004, VB6003, VA5140, VA5137, VA5054, VA5051, VA4132, VA4131, H4090, H4089, VA4052, VA4051, D1100, C1082, C1081, J1074, K1012 & K1011 are wheelchair accessible, roll-in shower only.

